

Exhibition Building

- 1 Obayashi Corporation
- 2 TAISEI CORPORATION
- 3 TOBISHIMA Corporation
- 4 TODA CORPORATION
- 5 TAKENAKA Corporation
- 6 OYO corporation
- 7 Asia Air Survey Co.Ltd.
- 8 Takasago Thermal Engineering Co.,Ltd.
- 9 NTT FACILITIES , INC
- 10 SOHGO SECURITY SERVICES CO.,LTD
- 11 KAJIMA CORPORATION
- 12 SHIMIZU CORPORATION
- 13 Maeda Corporation
- 14 Sumitomo Mitsui Construction Co.,Ltd.
- 15 NISHIMATSU CONSTRUCTION Co.,Ltd.
- 16 Tokyo Denkai Co., Ltd.
- 17 Airliquide Japan
- 18 TAIYO NIPPON SANSO Corporation
- 19 MAYEKAWA MFG. CO., LTD.
- 20 UBER CO.,LTD.
- 21,22 Advanced Accelerator Association
Promoting Science & Technology
- 23 Hitachi, Ltd.
- 24 Mitsubishi Electric Corporation
- 25 Hamamatsu Photonics K.K.
- 26 R&K Company Limited
- 27 NICHICON CORPORATION
- 28 Wuxi Creative Technologies Co.,ltd
- 29 Metal Technology Co. Ltd.

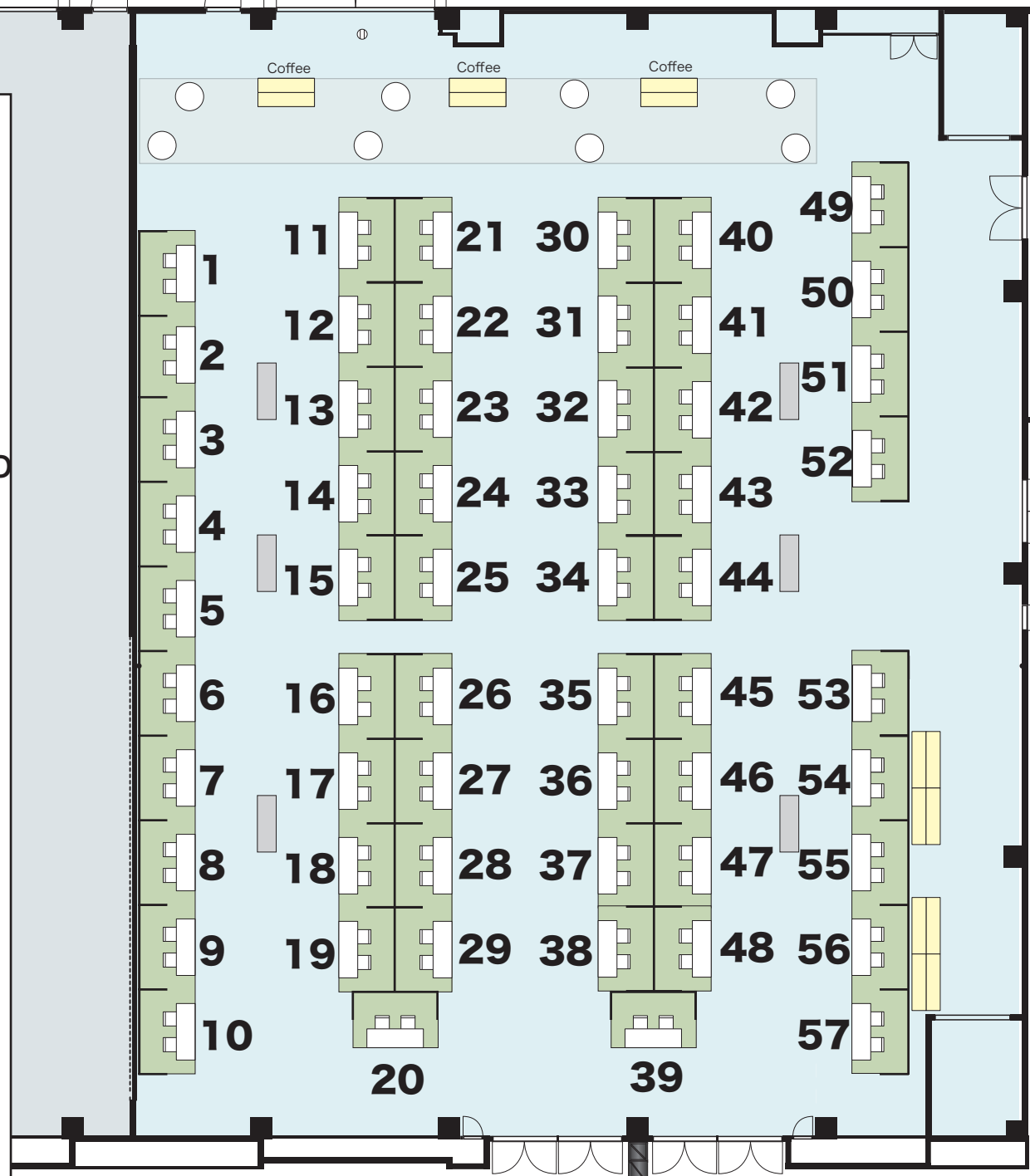

- 30,31 KYOCERA Corporation
- 32 Mitsubishi Heavy Industries, Ltd.
- 33 MITSUBISHI HEAVY INDUSTRIES
MACHINERY SYSTEMS, LTD.
- 34 Canon Electron Tubes & Devices
- 35 DAWONSYS Co.,Ltd.
- 36 ScandiNova Systems KK
- 37 Cosylab Japan
- 38 AMETEK Co., Ltd.
- 39 TOKYO BOEKI TECHNO-SYSTEM, LTD.
- 40 TOKIN Corporation
- 41 KUDO ELECTRIC CO.,LTD.
- 42 Iwate Iron Co.,Ltd.
- 43 TDC Corporation
- 44 MIRAPRO.CO.,LTD
- 45 Tosei EB Tohoku Co.,Ltd.
- 46 Fujikin Incorporated
- 47 Alpha Electronics Corporation
- 48 HAYASHI-REPIC CO., LTD.
- 49 Suzuki Kikai Co.,Ltd.
- 50 MARUI GALVANIZING CO.,LTD
- 51 Higashi-Nihon Kidenkaiatsu Co.,Ltd
- 52 WING Co.LTD
- 53 Akita Prefectural Research Society
for High Energy Accelerator Technology
- 54 SAKATA RIKAGAKU Co.,Ltd
- 55 VIC International Co., Ltd.
- 56 AKITA CHEMICAL INDUSTRIES Co.,Ltd
- 57 Sanei-Kikai Co.,Ltd

Hall 1

Conference Building

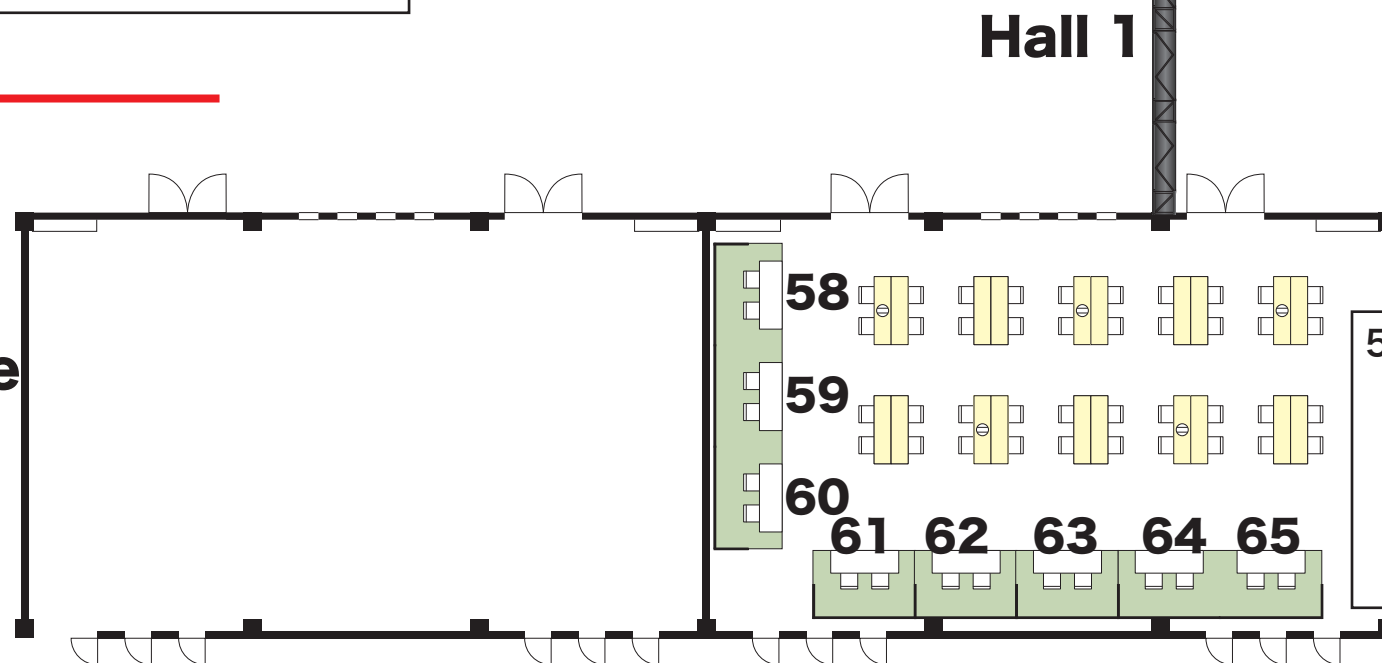

- 58,59,60 TOHOKU ILC Promotion Council
- 61 Miyagi Prefectural Government
- 62 Sendai City
- 63 Iwate Prefecture
- 64,65 Southern Iwate and Northern Miyagi Liaison Council
for the ILC

Subway Station

